

Capacity / Centre of gravity:
10,000 kg - 12,000 kg - 14,000 kg / 600 mm
Voltage 120 V
High performances and large manoeuvrability
Very compact size
Long autonomy of the battery
Travel speed: 8,1 mph
Lift speed: 70,9 fpm

SERIES



Z100 HD
Z120 HD
Z140 HD

MAIN FEATURES

- Capacity / Centre of gravity:
21800 lbs / 24 inch
26000 lbs / 24 inch
30500 lbs / 24 inch
- Voltage: 120 V
- Tires: DUAL SE-C
- Motors: AC
- Brakes: oil immersed
- Travel speed: 13 km/h
- Lifting speed: 0.36 m/s
- Battery 120 V – Maximum capacity 1500 Ah
- Multifunction display easy info (MDE)
- Rear view camera
- High positioned tilt cylinders

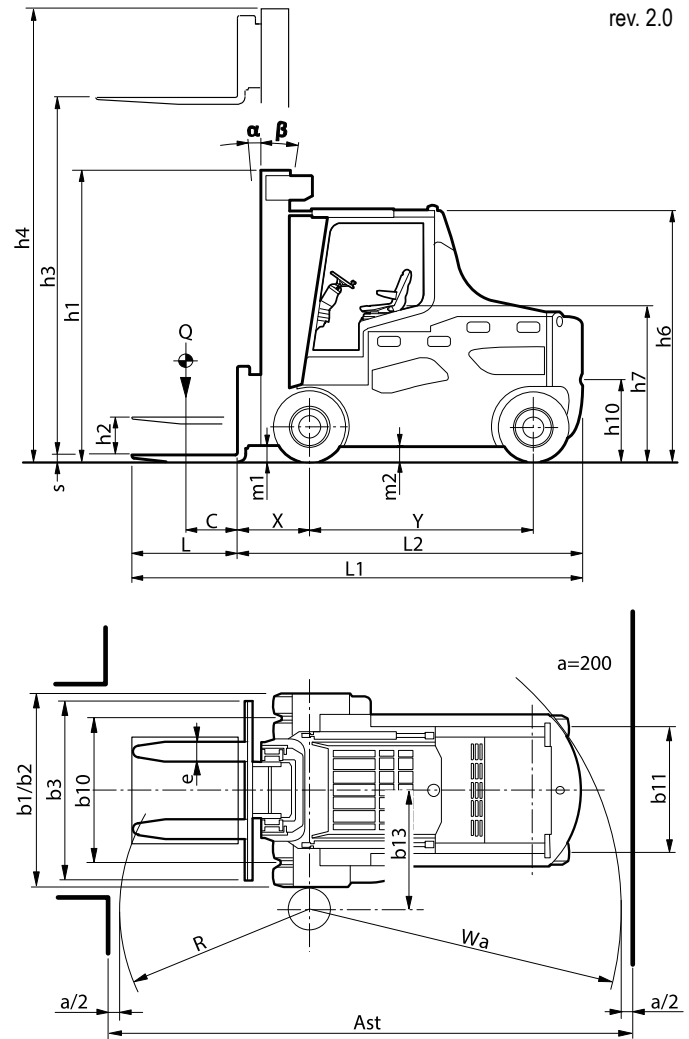

THE BENEFITS OF CHOOSING CARER

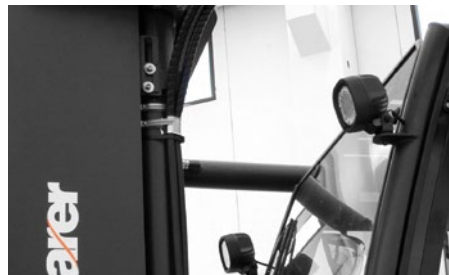

A forklift truck newly designed, developed at a voltage of 120V for maximum efficiency and long work autonomy, the Z100-140 HD is the ideal truck for moving heavy loads with maximum safety and reliability.

Specifications

The technology of 120V and the machine's development based on the concepts of power and efficiency, provide high performance and long autonomy

of the battery. The power of the motor, electronically controlled, gives these trucks very good acceleration, high speed and unmatched manoeuvrability. The acceleration is gentle and progressive and it is used only when needed to reduce consumption and increase the autonomy of work.

Maximum operator comfort

The cabin separated from the frame, gives to the operator very

high level of comfort.

Fitted on silent blocks system, it reduces the vibrations and noise. From the driver's seat is perfectly dominates all the surrounding space and all dimensions of the truck are easily perceptible.

The visibility remains good even during the handling of bulky loads, giving to the operator an optimum driving position for maximum visibility and increasing the safety of the vehicle.

		C.A.R.E.R. Srl				
IDENTIFICATION	1.1	Manufacturer				
	1.2	Manufacturer's type designation	Z100HD	Z 120 HD	Z 140 HD	
	1.3	Drive	electric	electric	electric	
	1.4	Operator type	seat	seat	seat	
	1.5	Load capacity/rated load	Q (t)	10	12	14
	1.6	Load centre distance	C (mm)	600	600	600
	1.8	Load distance	X (mm)	815 ⁽¹⁾⁽²⁾	815 ⁽¹⁾⁽²⁾	815 ⁽¹⁾⁽²⁾
	1.9	Wheelbase	Y (mm)	2550	2550	2650
	WEIGHTS	2.1	Weight	(kg)	17400	19400
2.2		Axle loading, laden front / rear	(kg)	24100 / 3300	28800 / 2600	31300 / 3100
2.3		Axle loading, unladen front / rear	(kg)	8550 / 8850	10140 / 9260	9820 / 10580
WHEELS	3.1	Tyres type	C-SEG		C-SEG	SEG
	3.2	Tyre size, front	711x(254+254) 300-15		711X(315+315) 355/50-20	355/50-20
	3.3	Tyre size, rear	711x254 300-15		711x254 300-15	355/50-20
	3.5	Wheels, number front rear (x = driven wheels)	2X/2 (SEG:4X/2)		4X/2	4X/2
	3.6	Track width, front	b10 (mm)	1692 1645	1795 1795	1795
	3.7	Track width, rear	b11 (mm)	1450 1450	1450 1450	1472
	DIMENSIONS	4.1	Tilt of mast / fork carriage forward / backward	α/β (°)	7/8 ⁽²⁾	7/8 ⁽²⁾
4.2		Closed mast height	h1 (mm)	3050	2950	2950
4.3		Free lift	h2 (mm)	0	0	0
4.4		Lift (standard mast)	h3 (mm)	3400	3400	3400
4.5		Height, mast extended	h4 (mm)	4850	4850	4850
4.7		Height of overhead guard	h6 (mm)	2850	2850	2850
4.8		Seat height	h7 (mm)	1790	1790	1790
4.12		Coupling height	h10 (mm)	910	910	910
4.19		Overall length	L1 (mm)	5115	5115	5265
4.20		Length to face of forks	L2 (mm)	3915	3915	4065
4.21		Overall width	b1/b2 (mm)	2200 2200	2300 2350	2350
4.22		Fork dimensions	ExSxL (mm)	200x60x1200	200x70x1200	200x70x1200
4.23		Fork carriage iso 2328/30, FEM/A,B		5A	CARER	CARER
4.24		Fork-carriage width	b3 (mm)	2000	2000	2000
4.31		Ground clearance, laden, below mast	m1 (mm)	180	180	180
4.32		Ground clearance, centre of wheelbase	m2 (mm)	130	130	130
4.33	Aisle width for pallets 1000x1200 crossways	Ast (mm)	5620	5670	5850	
4.34	Aisle width for pallets 800x1200 lengthways	Ast (mm)	5820	5870	6050	
4.35	Turning radius	Wa (mm)	3600	3650	3800	
4.36	Internal turning radius	b13 (mm)	1450	1515	1650	
PERFORMANCE	5.1	Travel speed, laden / unladen	(km/h)	12.5 / 13	11 / 11,5	10 / 10.5
	5.2	Lift speed, laden / unladen	(m/s)	0.25 / 0.36	0.21 / 0.36	0.21 / 0.36
	5.3	Lowering speed, laden / unladen	(m/s)	0.5 / 0.4	0.5 / 0.4	0.5 / 0.4
	5.5	Drawbar pull, laden / unladen (S2 60')	(N)	11000 / 12000	14000 / 15000	13000 / 15000
	5.6	Max. drawbar pull, laden / unladen (S2 5')	(N)	30000 / 31000	36000 / 38000	36000 / 38000
	5.7	Gradeability, laden / unladen (S2 30')	(%)	9 / 15	9 / 16	8 / 15
	5.8	Max. gradeability, laden / unladen (S2 5')	(%)	11 / 18	11 / 20	10 / 18
	5.9	Acceleration time, laden / unladen (10 m)	(s)	7 / 6,2	7 / 6,2	8 / 7
	5.10	Service brake		hydraulic / electric	hydraulic / electric	hydraulic / electric
	MOTOR / BATT.	6.1	Drive motor rating (S2 60')	(kW)	35	35
6.2		Lift motor rating (S3 20%)	(kW)	45	45	45
6.4		Battery voltage	U (V)	120	120	120
6.4.1		Rated capacity	K5 (Ah)	1260 / 1380 / 1500	1380 / 1500	1380 / 1500
6.5		Battery weight minimum/maximum	(kg)	5000 / 5650	5400 / 5650	5400 / 5650
6.6		Type of drive control		inverter	inverter	inverter
OTHERS	8.1	Operating pressure for attachments	(bar)	200	200	200
	8.2	Sound level at the driver's ear	(dBA)	-	-	0
	8.4	Sound level at the driver's ear	(dBA)	-	-	-

(1) With side-shifter integrated in the mast. (2) Depending on kind of mast.

Wheels tire legend: SE super elastic - SEGEM super elastic twins - C cushion - L pneumatic - VLK vulkolan: for tyres NO MARKING - OIL RESISTANT, please contact Carer.
The performance data refer to a forklift truck in perfect working condition, with battery weight corresponding to the values given in 6.5.

In accordance with VDI Guideline 2198 this specification sheet provides details of the standard truck only. Non-standard tires, different masts, optional equipment, etc. may result in different values.
The C.A.R.E.R. products and specifications are subject to change without notice.



C.A.R.E.R. Srl
via Copernico 13
48033 Cotignola (RA) Italy
phone +39 0545 1938010
fax +39 0545 908070
www.carerforklift.com
info@carerforklift.com

follow us on 